

Gelijkvloers

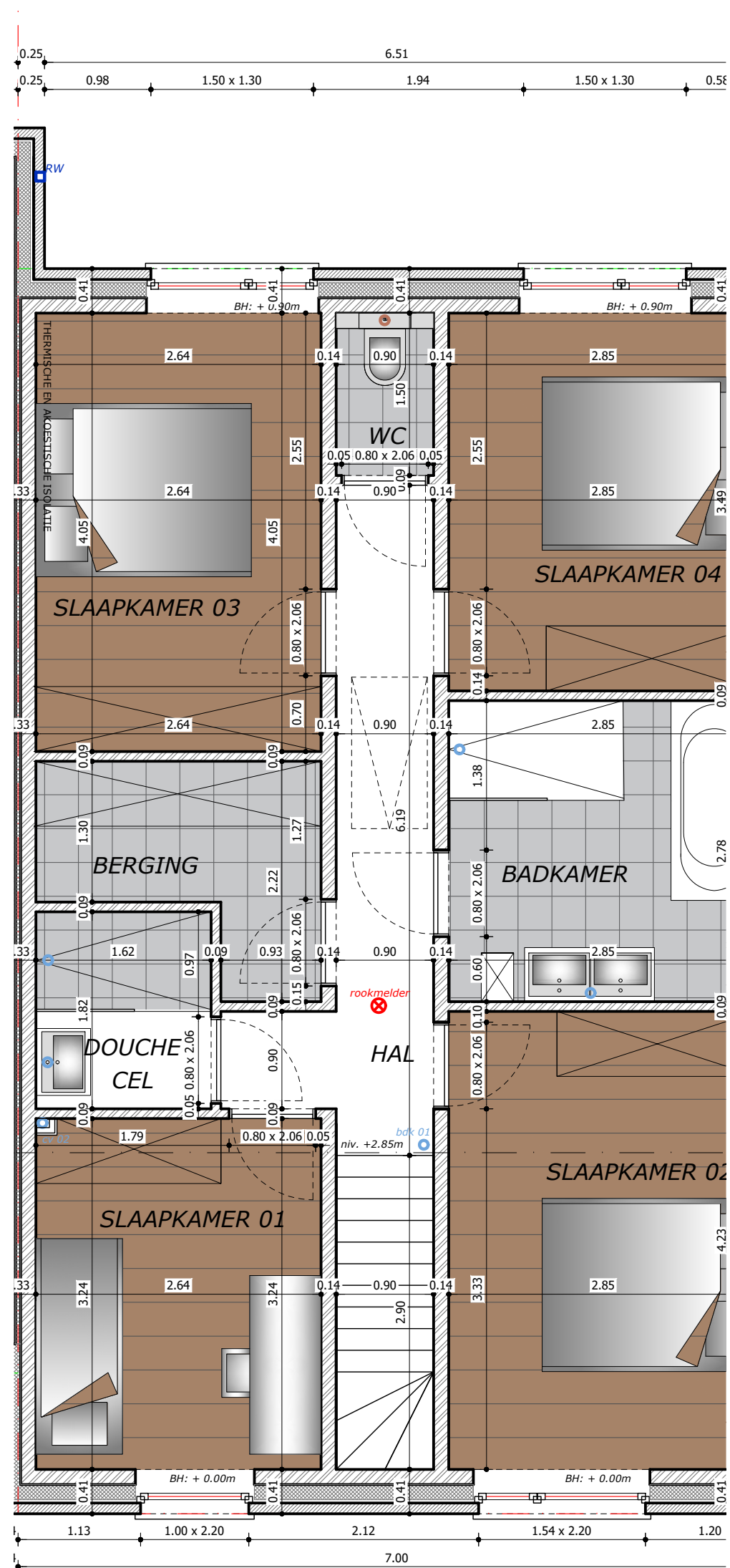

Verdieping 01

Lot 4
 Oppervlakte perceel: 169,35m²
 Totaal bewoonbare oppervlakte: 139,85m²



WATERDOORLATENDE VERHARDING = 19,65m²
 GROEN = 50,12m²
 DAKOPP. WONING = 80,48m²
 DAKOPP. TUINHUIS = 9,00m²

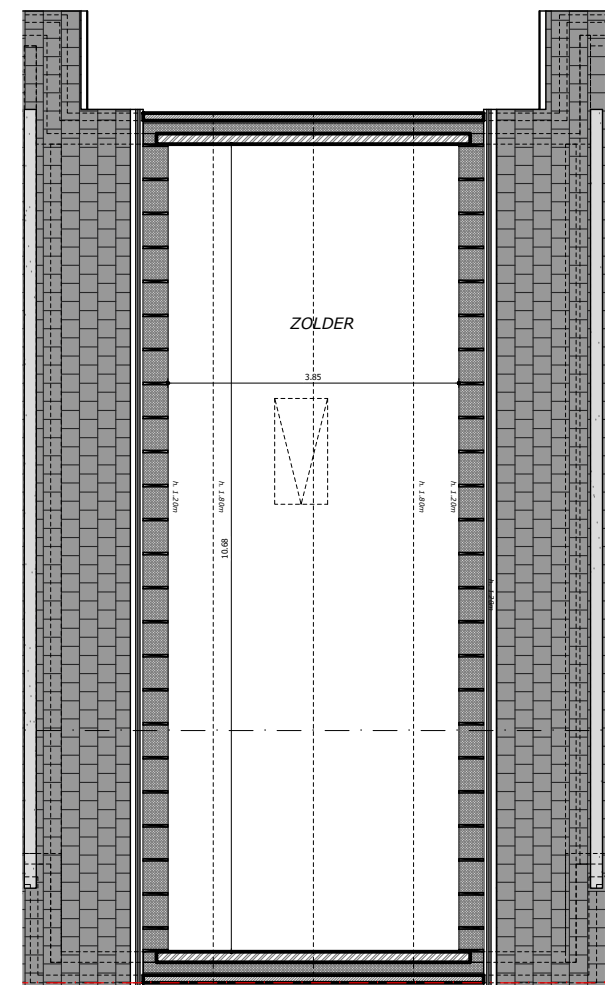
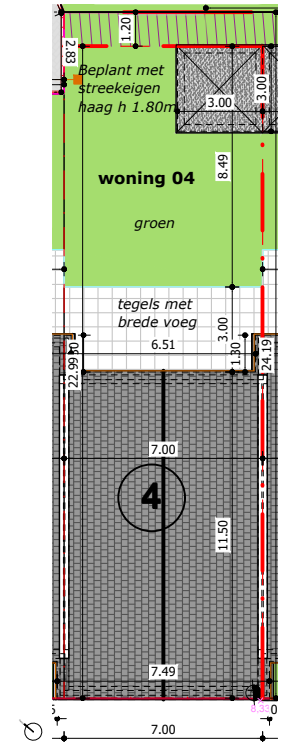

Zolder